

# MAGICSUB

LAMP WITH STAINLESS STEEL FLANGE,  
INLET, DIFFUSER and 4m of CABLE

Cod.7904794790

MAGIC SUB WHITE 3000K 16°



Fixed colour LED lamp for pool, ideal for small pools, jacuzzi areas and steps. Inlet provided for installation in restricted spaces. For panel and reinforced concrete with tiles or pool liner.

## Technical data

|                             |                          |
|-----------------------------|--------------------------|
| Power supply                | 12 V AC                  |
| Current                     | 0.8 A                    |
| Maximum power consumption   | 5 W                      |
| Apparent maximum power      | 7 VA                     |
| Insulation class            | III                      |
| Connection                  | 4 m IMMERSION CABLE 2X1  |
| Maximum cable length        | 48 m                     |
| Coverage area m2            | 5 - 10                   |
| Beam angle                  | 16°                      |
| Number of LEDs              | 3                        |
| LED color                   | WARM WHITE (3000K)       |
| Total luminous flux         | 690 lm                   |
| Body                        | AISI316L STEEL, GLASS    |
| Weight                      | 0.5 kg                   |
| Protection rating           | IP68                     |
| Working conditions          | EXCLUSIVELY IN THE WATER |
| Maximum ambient temperature | MAX +40 °C               |

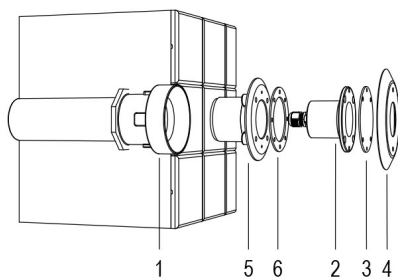

1. WALL ADAPTER
2. LAMP
3. OPTICAL DIFFUSER
4. FRONT FLANGE
5. INLET FITTING
6. GASKET

## Related documentation:

### Manuale utente IT:

[man\\_7904794790\\_it.pdf](#)

### Certificato CE IT:

[ce\\_7904794790\\_it.pdf](#)

### User manual EN:

[man\\_7904794790\\_en.pdf](#)

### CE certification EN:

[ce\\_7904794790\\_en.pdf](#)

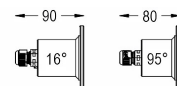
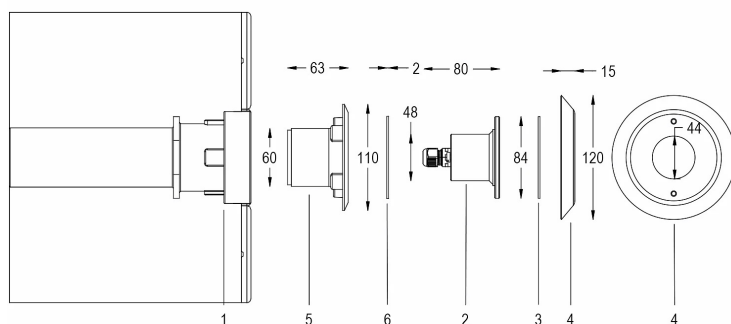

### FIX / RGBW OC:

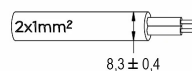

### RGBW DMX:

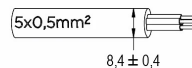

14/10/2024 - The data in this document may be changed without notice in order to improve the product or to correct any errors.