

MAGICSUB

LAMP WITH STAINLESS STEEL FLANGE,
INLET, DIFFUSER and 4m of CABLE

Cod.7904794700

MAGIC SUB WHITE 5300K 16°



Fixed colour LED lamp for pool, ideal for small pools, jacuzzi areas and steps. Inlet provided for installation in restricted spaces. For panel and reinforced concrete with tiles or pool liner.

Technical data

Power supply	12 V AC
Current	0.8 A
Maximum power consumption	5 W
Apparent maximum power	7 VA
Insulation class	III
Connection	4 m IMMERSION CABLE 2X1
Maximum cable length	48 m
Coverage area m2	5 - 10
Beam angle	16°
Number of LEDs	3
LED color	COLD WHITE
Total luminous flux	790 lm
Body	AISI316L STEEL, GLASS
Weight	0.5 kg
Protection rating	IP68
Working conditions	EXCLUSIVELY IN THE WATER
Maximum ambient temperature	MAX +40 °C

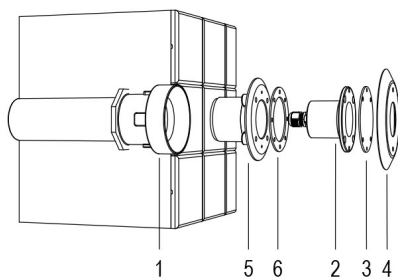

1. WALL ADAPTER
2. LAMP
3. OPTICAL DIFFUSER
4. FRONT FLANGE
5. INLET FITTING
6. GASKET

Related documentation:

Manuale utente IT:
[man_7904794700_it.pdf](#)

Certificato CE IT:
[ce_7904794700_it.pdf](#)

User manual EN:
[man_7904794700_en.pdf](#)

CE certification EN:
[ce_7904794700_en.pdf](#)

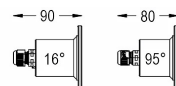
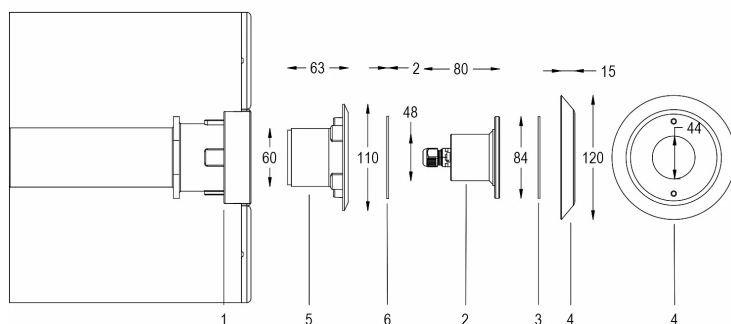

FIX / RGBW OC:

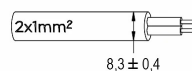

RGBW DMX:

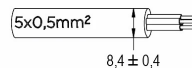

14/10/2024 - The data in this document may be changed without notice in order to improve the product or to correct any errors.